



TORINCAB2 s.r.l.

SEDE LEGALE ED AMMINISTRATIVA:
Via DRUBIAGLIO 6/17
10040 Frazione RIVERA – ALMESE (TO)
TEL. +39 (0) 119352688
FAX. +39 (0) 119352838
Web: www.torincab2.com

Cap. Soc. € 10.000,00
Isc. al Reg. delle Imp. di Torino N. 05655530011
Albo Imprese Artigiane N. 307836
Partita IVA e Cod. Fisc. 05655530011
E-mail: info@torincab2.com

CABIN FOR TRACTORS:
New Holland T4.80N - T4.90N - T4.100N - T4.110N –T4.120N Stage V

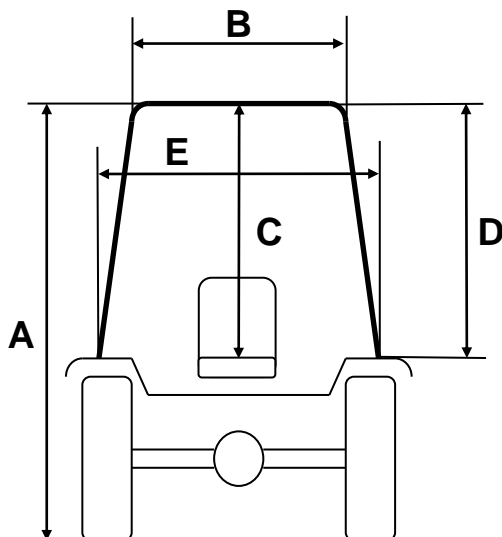

Cabina New Holland T4.90N Stage V	
Tractor Tyres 380/70 R.24	
<i>Rear fenders in TALL position</i>	
A	2280 mm
B	1000 mm
C	1010 mm
D	970 mm
E	1130 mm

