



TORINCAB2 s.r.l.

SEDE LEGALE ED AMMINISTRATIVA:
Via DRUBIAGLIO 6/17
10040 Frazione RIVERA – ALMESE (TO)
TEL. (0039) 0119352688
FAX. (0039) 0119352838
Sito: www.torincab2.com

Cap. Soc. € 10.000,00
Isc. al Reg. delle Imp. di Torino N. 05655530011
Albo Imprese Artigiane N.307836
Partita IVA e Cod. Fisc. 05655530011
E-mail: info@torincab2.com

NEW CABIN FOR TRACTOR:

BCS

VOLCAN SDT v800 = 750-850-950

DUALSTEER

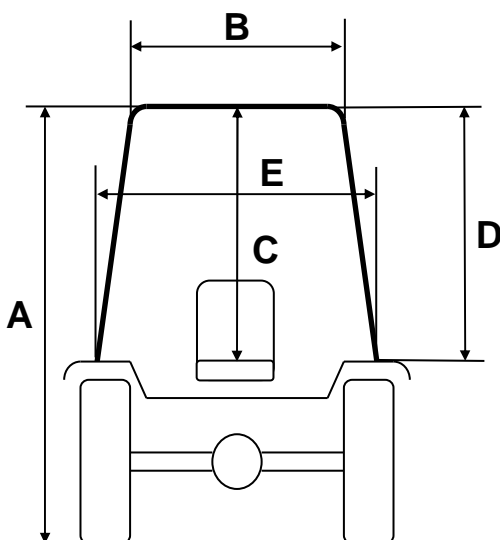

Cabin for BCS VOLCAN SDT V950 DUALSTEER
Back Tyres 320/70 R.24

A	2080 mm
B	910 mm
C	1010 mm
D	880 mm
E	990 mm

